

**BXQ 1508
to
BXQ 1743**

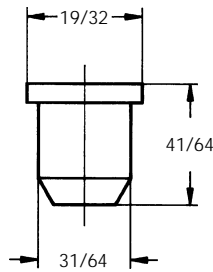

**BXQ 1149
to
BXQ 1372**

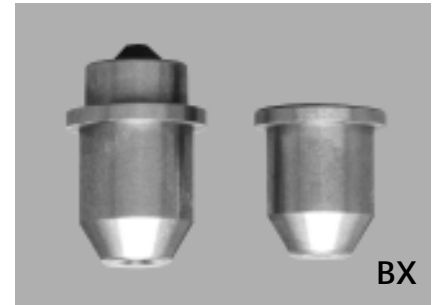

BX

BX full-cone tips are designed to be assembled onto a 3/8" threaded nipple, by means of a locknut and a seal. This assembly allows for easy and fast replacement of a clogged nozzle.

A variety of assembly fittings is available, two of which are shown below.

Materials: Brass (T1)
303 stainless steel (B1) on request

Nozzle code	D	Flow rates (gpm) at various pressures (psi)											Spray angle		
													20	40	100
		3	5	7	10	20	30	40	60	80	100	150	psi	psi	psi
BXQ1149xx	0,047	-	-	-	0.19	0.27	0.33	0.38	0.47	0.54	0.60	0.74	50	50	46
BXQ1223xx	0,059	-	-	-	0.28	0.40	0.49	0.57	0.70	0.80	0.90	1.1	65	65	59
BXQ1262xx	0,063	-	-	0.28	0.33	0.47	0.58	0.67	0.82	0.95	1.1	1.3	50	50	46
BXQ1372xx	0,079	-	0.34	0.40	0.47	0.67	0.82	0.95	1.2	1.3	1.5	1.8	65	65	59
BXQ1508xx	0,090	0.36	0.46	0.54	0.65	0.92	1.1	1.3	1.6	1.8	2.1	2.5	50	50	46
BXQ1626xx	0,114	0.44	0.56	0.67	0.80	1.1	1.4	1.6	2.0	2.3	2.5	3.1	60	60	55
BXQ1743xx	0,114	0.52	0.67	0.79	0.95	1.3	1.6	1.9	2.3	2.7	3.0	3.7	67	67	61

Most BX nozzle tips can be furnished with a 3/8" female thread, under the code BJQ. Specify BJQ instead of BXQ, and add the suffix **SN** after the material designator code.

For example, instead of ordering tip BXQ1149T1, specify **BJQ1149T1SN**.

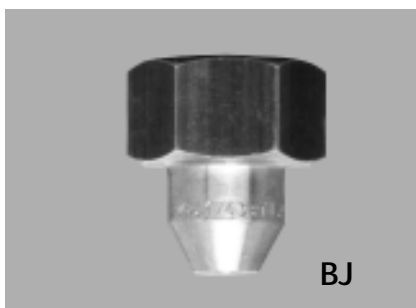

BJ

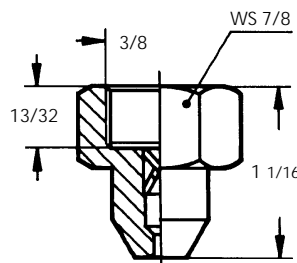

BX nozzle tips are usually assembled by using a welding nipple and a locknut. Refer to the Accessories section of this catalog.

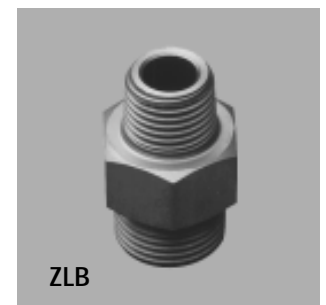

ZLB