

SPECIAL PURPOSE PRODUCTS

HOT WATER WASH GUN/LANCES

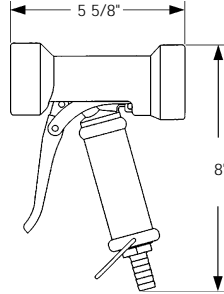

The **UMV** series wash gun is designed to minimize hot water usage and to provide comfortable and convenient operation.

Its thick rubber cover effectively protects the operator's hands from hot temperatures. It also provides protection against damage in case the gun is dropped and is resistant to grease and detergents.

The trigger is designed for comfort and can be operated for long periods without causing discomfort. A lock ring at the base of the gun is provided to allow operation in a locked-on position.

An adjustment knob at the rear of the gun permits adjusting the pattern from a straight jet to a large-angle spray.

Connection: 1/2" hose fitting

Materials:

Body: Brass casting, nickel-plated
 Cover: EPDM
 Stem: 316 stainless steel
 Trigger: 316 stainless steel, rubber-lined

Weight: 2 lbs

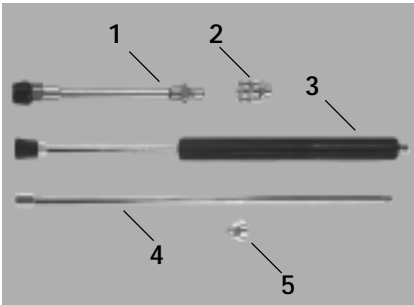

Pictured at the left are lances that can be used with the UMV 2210 T5 wash gun along with a quick-release coupling and nipple.

In addition to the foam lance, which is self-contained, general purpose lances with 1/4" female threads to accommodate most flat-jet, full-cone and straight-jet nozzles are shown.

Below are the ordering codes and descriptions for the lances and accessories.

No.	Code	DESCRIPTION	MATERIAL	L	UF	WF
1	XUM V001 B3	Foam lance	316 stainless steel	12"		
2	XUM V002 B3	Quick release coupling for for foam lance	316 stainless steel			
3	XUM V003 B3	Protected lance; nozzle protected with bushing	316 stainless steel	20"	1/4"	1/4"
4	XUM V004 B3	Unprotected lance; nozzle protected with bushing	303 stainless steel	20"	1/4"	1/4"
5	XUM V005 T8	Nipple	Chrome plated brass		1/4"	1/2"

HIGH-PRESSURE SPRAY GUNS/LANCES

UMW 0010 D4

The **UMW 0010 D4** is a spray gun designed to operate at high pressures and temperatures. It features a heat-resistant nylon trigger that makes it comfortable to use at elevated temperatures. The trigger provides positive control, which helps reduce the amount of water that is wasted.

Connection: 3/8" female inlet thread
3/8" female outlet thread

Materials: Body: Fiberglass reinforced nylon
Interior: Brass
303 stainless Steel
440 stainless Steel

Standard pressure: 2900 psi
Maximum pressure: 3200 psi
Standard flow rate: 8 gpm
Maximum temperature: 320° F
Weight: 0.6 lbs

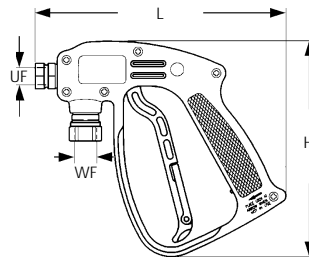

Code	WF	UF	H	L
UMW0010D4SN	3/8"	3/8"	6 3/8"	7 1/4"

UMW 0020 D4

The **UMW 0020 D4** spray gun offer the same features as the UMW 0010 D4 gun, but with a higher pressure capability.

Connection: 3/8" female inlet thread
1/4" female outlet thread

Materials: Body: Fiberglass reinforced nylon
Interior: Brass
303 stainless Steel
440 stainless Steel

Standard pressure: 3600 psi
Maximum pressure: 4050 psi
Standard flow rate: 10.5 gpm
Maximum temperature: 320° F
Weight: 0.6 lbs

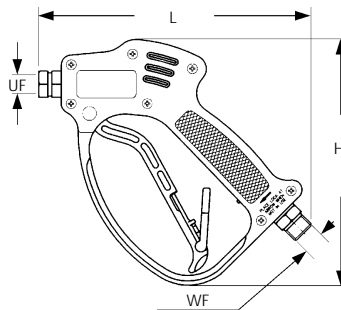

Code	WF	UF	H	L	WEIGHT (lbs)
UMW0021D4SN	3/8"	1/4"	7 1/4"	8"	1.7

HIGH PRESSURE LANCES

A range of high quality pressure lances for UMW pressure guns is available.

Please contact us for information on specific models.

