

LOCK NUTS

**VAA** lock nuts are designed for use with the **Z** series nipples. (See the following page.)

Connection: Female thread

Materials: 303 stainless steel (B1)  
 316 stainless steel (B3)  
 Brass (T1)  
 Fiberglass reinforced polypropylene (D6)  
 Other materials available on request

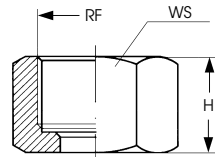

Code	RF	DIA	H	WS
VAA 0038 xx	3/8"	1/2"	1/2"	7/8"
VAA 0075 xx	3/4"	13/16"	5/8"	1 1/4"
VAA 0125	1 1/4"	15/16"	1 1/16"	2"



VAA

Lock nut **VAB 0125 D6B** is designed to be used with ZPF and ZPL series nozzle mounting clamps. Due to its large size, the nut can easily be hand tightened.

The nut is made from polypropylene, which minimizes water absorption, and provides excellent dimensional stability under operating conditions. It also maintains its tensile strength at elevated temperatures.

Connection: Female thread

Materials: Polypropylene

Maximum temperature: 175° F

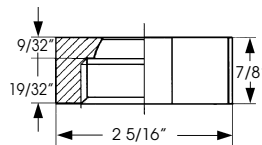

VAB

Blind cap **VAE** is used blank off the ends of spray manifolds in surface pre-treatment plants. It is molded from polypropylene.

Connection: Female thread

Material: Polypropylene

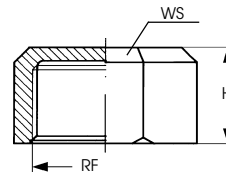

Code	RF	H	WS
VAE 0075 D2	3/4"	7/8"	15/16"
VAE 0100 D6	1"	1"	15/8"
VAE 0125 D6	1 1/4"	1 1/4"	2"
VAE 0150 D6	1 1/2"	1 1/4"	23/8"



VAE