

ACCESSORIES

NIPPLES

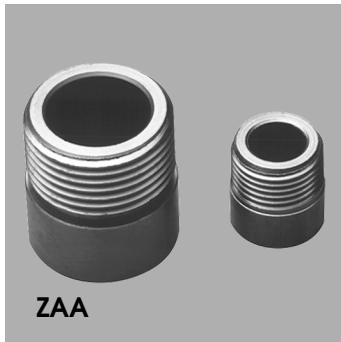

ZAA

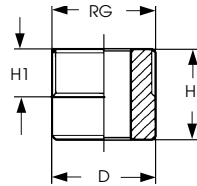

ZAA series welding nipples are used to assemble **GX** nozzle tips onto pipes and spray manifolds.

Connection: Male thread and flange

Materials: 303 stainless steel (B1)
316 stainless steel (B3)
Carbon (tool) steel (A2)
Brass (T1)
PVC (D1)

Code	RG	D	DP	H	H1
ZAA 1738 xx	3/8"	1 1/16"	7/16"	1 1/16"	1 3/32"
ZAA 2775 xx	3/4"	1 1/16"	1 1/16"	1 1/16"	9/16"

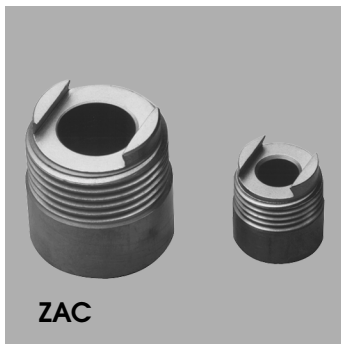

ZAC

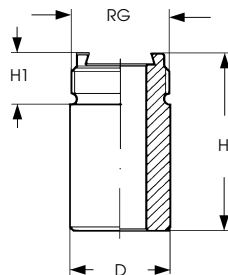

ZAC series welding nipples incorporate a dovetail that mates to the same feature on **GY** nozzle tips.

Connection: Male thread and flange

Materials: 303 stainless steel (B1)
316 stainless steel (B3)
Carbon (tool) steel (A2)

Code	RG	D	DP	H	H1
ZAC 1738 xx	3/8"	1 1/16"	9/32"	1 1/16"	1 3/32"
ZAC 2775 xx	3/4"	1 1/16"	9/16"	1 1/16"	9/16"
ZAC 4225 xx	1 1/4"	1 5/8"	7/8"	1 9/16"	7/8"

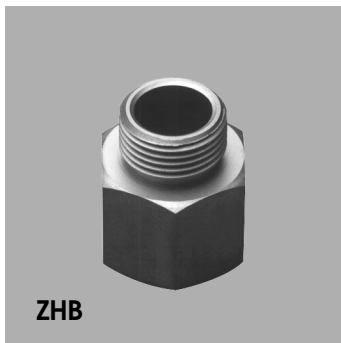

ZHB

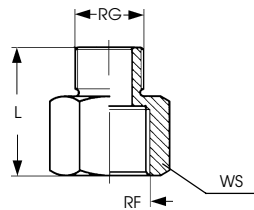

ZHB series nipples are threaded at both ends.

Connection: Female and male threads

Materials: 303 stainless steel (B1)
316 stainless steel (B3)
Brass (T1)

Code	RF	RG	L	WS
ZHB 2538 xx	1/4"	3/8"	1"	5/8"
ZHB 3838 xx	3/8"	3/8"	1"	5/8"
ZHB 7575 xx	3/4"	3/4"	1 5/16"	1 1/4"

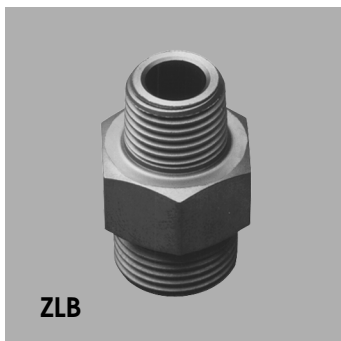

ZLB

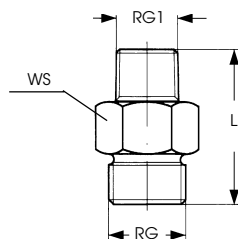

ZLB series nipples are threaded at both ends.

Connection: Male threads, both ends

Materials: 303 stainless steel (B1)
Brass (T1)

Code	RG	RG1	L	WS
ZLB 2538 xx	1/4"	3/8"	1"	5/8"
ZLB 3838 xx	3/8"	3/8"	1"	5/8"
ZLB 7575 xx	3/4"	3/4"	1 5/16"	1 1/4"

WALL MOUNTING NIPPLE

XMW nipples have been designed to attach MW series nozzles directly to tank walls or sheet metal air ducts.

By means of its internal thread, the nipple is fitted onto the nozzle, replacing the standard nut XMW 0010 xx. The 3/4" external thread can be connected to a through hole into the wall or duct.

The safety locknut, VAC 0076 xx provides secure attachment, even on thin walls.

Connection: 3/4" external thread.

Materials: 303 stainless steel (B1)
Brass (T1)



ACCESSORIES

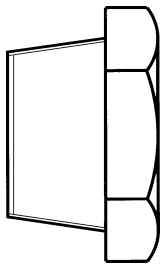

XMW 0021 xx SN

Minimum wall thickness for a fitting without ring nut = 0.4"

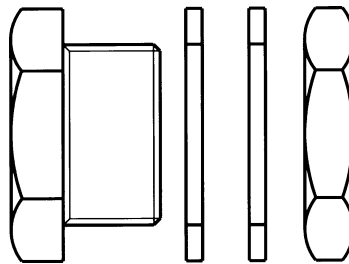

XMW 0025 xx

The kit includes:

- Nipple: XMW 0020 xx SN
- Locknut: VAC 0076 xx SN
- Gasket: VDA 0075 P7

Minimum wall thickness for a fitting with ring nut = 0.4"

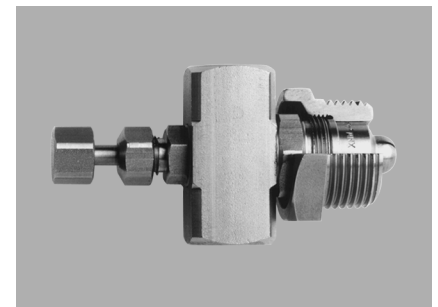

Shown is nipple XMW 0021 xx mounted on a MW nozzle.

VF type nipples are available both with a completely cylindrical outer wall (VFA) and with a hexagonal section (VFB).

Connection: Female thread

Materials: 303 stainless steel (B1)
316 stainless steel (B3)
Brass (T1)

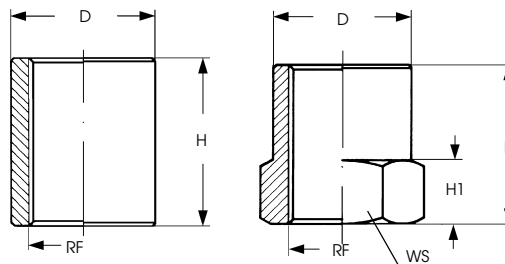

FEMALE NIPPLES



Code	RF	D	H	H1	WS
VFA 0025 xx	1/4"	3/4"	15/16"	-	-
VFA 0038 xx	3/8"	7/8"	11/16"	-	-
VFA 0050 xx	1/2"	11/16"	13/16"	-	-
VFA 0075 xx	3/4"	11/4"	13/8"	-	-
VFB 0012 xx	1/8"	7/32"	3/4"	25/64"	9/16"
VFB 0025 xx	1/4"	21/32"	3/4"	25/64"	11/16"
VFB 0038 xx	3/8"	27/32"	3/4"	25/64"	7/8"
VFB 0050 xx	1/2"	11/16"	13/16"	19/32"	11/16"
VFB 0075 xx	3/4"	11/4"	19/16"	25/32"	11/4"